

# Assembly Instruction

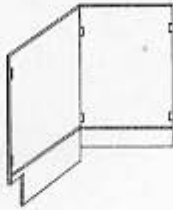

## Step1

Aims at on the side panel on fastener and the back panel fastener inserts afterwards, and then fasten them using screwdriver to turn camlock 180 degree clockwise.

B09	B12	B15	B18	B21	B24	B27	B30	B33	B36
B39	B42	B45	B48	SCB36	SCB42	SCB48	SB60		
VB1221	VB1518	VB1521	VB1818	VB1821	VB2421				
VB3021	VB1218	VB1221	VB1518	CVSB6021					
CVSB3618	CVSB3621	CVSB3921	CVSB4221	CVSB4821					

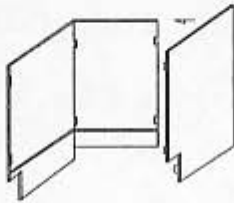

## Step2

With first step of same, other leans together the side panel and the back panel connection.

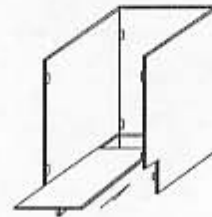

## Step3

Insert bottom panel in the grooves at the side panels.

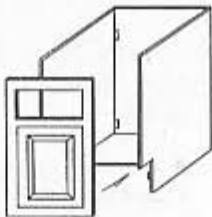

## Step4

Aims at on the side panels after the facade in fastener the fastener inserts, and then fasten them using screwdriver to turn camlock 180 degree clockwise.

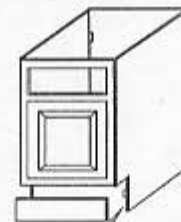

## Step5

Facade under board and about side panels connection

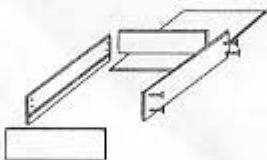

## Step6

Assembly the drawer

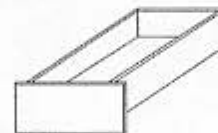

## Step7

Finally, the drawer which assembles installs to the cabinet in.